

**THIS IS SCHEDULE 3 TO  
OFFICIAL PLAN AMENDMENT  
NUMBER \_\_\_\_.**

**SCHEDULE  
'A4'  
LAND USE**

THE CORPORATION OF  
THE MUNICIPALITY OF  
TEMAGAMI

SCALE 1:4,000

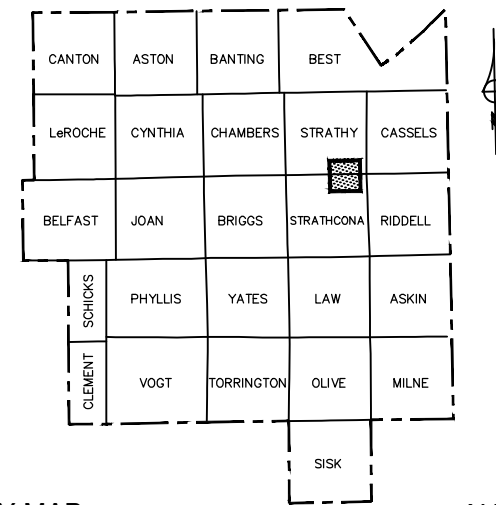
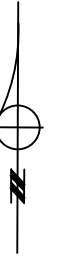
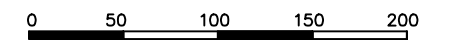

KEY MAP

N.T.S.

**LEGEND**

- PARKS AND OPEN SPACE
- RESIDENTIAL
- NEIGHBOURHOOD COMMERCIAL
- FUTURE DEVELOPMENT
- RAILWAY
- SETTLEMENT BOUNDARY

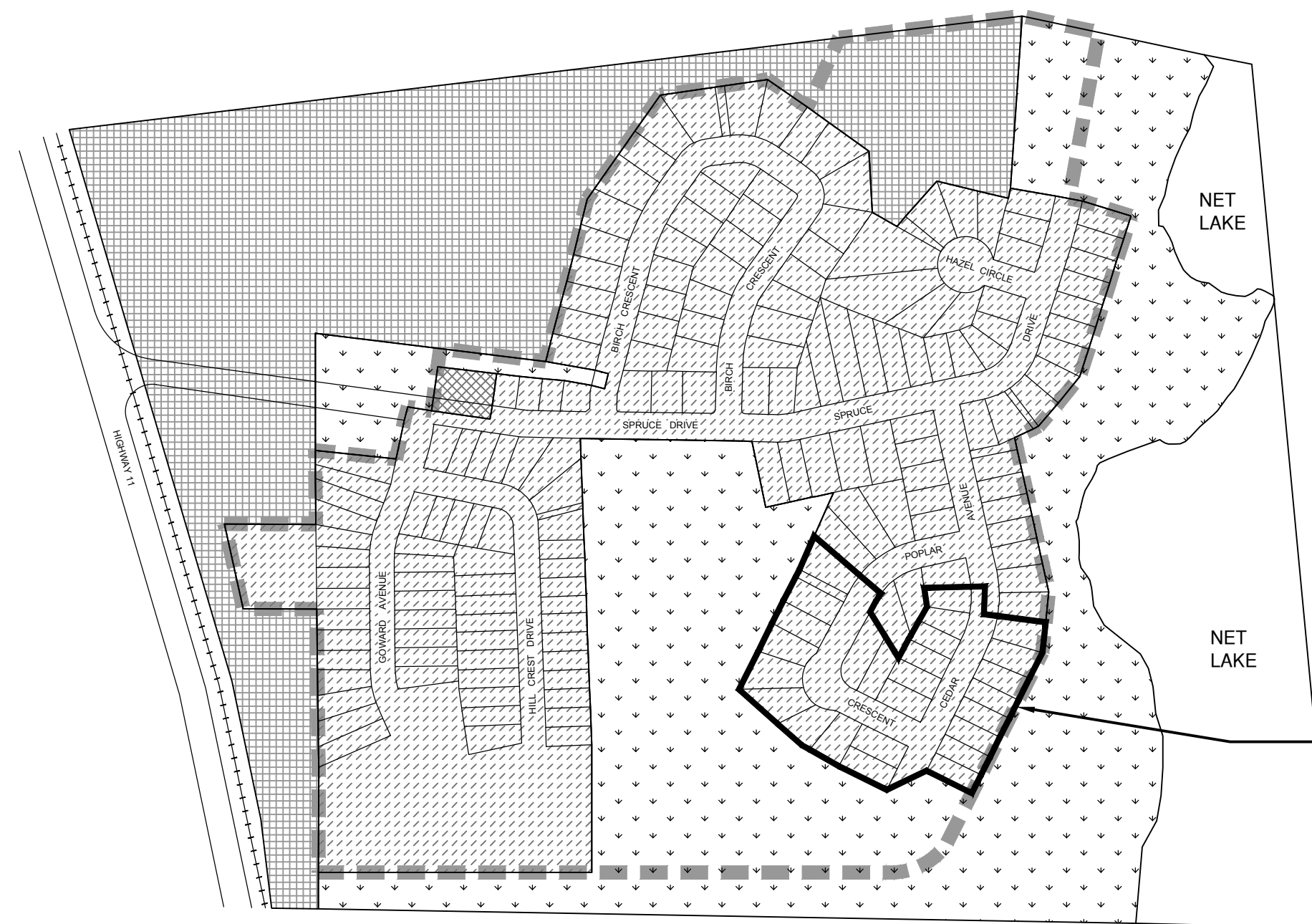

THE AREA OF LAND OUTLINED WITHIN THE SOLID BLACK LINE, AND ALL APPLICABLE POLICIES, DOES NOT COME INTO EFFECT UNTIL THE ISSUANCE OF AN ONTARIO MUNICIPAL BOARD ORDER FOR AN APPEAL OF OFFICIAL PLAN AMENDMENT NO. 6 TO THE OFFICIAL PLAN FOR THE TOWNSHIP OF TEMAGAMI, APPROVED AUGUST 26, 1986, OMB FILE 0950172, MINISTER'S FILE 48-OP-0054-006. UNTIL THE BOARD'S ORDER ISSUES, THE LAND USE DESIGNATION AND ALL APPLICABLE POLICIES FROM THE OFFICIAL PLAN FOR THE TOWNSHIP OF TEMAGAMI SHALL REMAIN IN EFFECT.

**URBAN NEIGHBOURHOOD - TEMAGAMI NORTH**

**NOTES:**

THIS SCHEDULE FORMS PART OF THE OFFICIAL PLAN OF THE MUNICIPALITY OF TEMAGAMI AND MUST BE READ IN CONJUNCTION WITH THE TEXT AND OTHER SCHEDULES.

FLOOD ELEVATIONS (ASL) - LAKE TEMAGAMI (284.7m), NET LAKE (288.0m), RABBIT LAKE (292.34m), SNAKE LAKE (292.5m), CASSELS LAKE (292.5m), LADY EVELYN LAKE (289.09m).

REVISED MAY, 2012  
REVISED SEPTEMBER, 2011  
REVISED JULY, 2011  
REVISED AUGUST 18, 2004